



ACQUAZZONE



INSTRUCTION

SEVILLA 1110

SIZE: 110x90x220sm



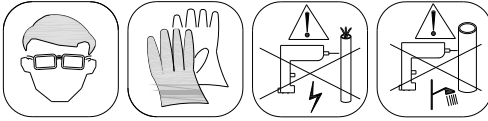

We appreciate your choosing of our shower products, and wish you a pleasant experience with our products and service. Please read Instruction carefully before installation.

IMPORTANT

Please check the shower enclosure for transport damage and completeness before installation. Complaints made following installation cannot be accepted.

Please read carefully the following instructions before installing your shower enclosure to ensure safe and proper use and avoid any injury to either the installer or user .Failure to comply may invalidate your guarantee.

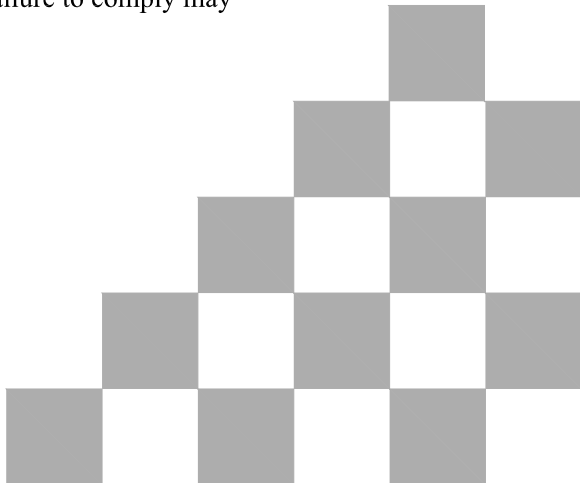

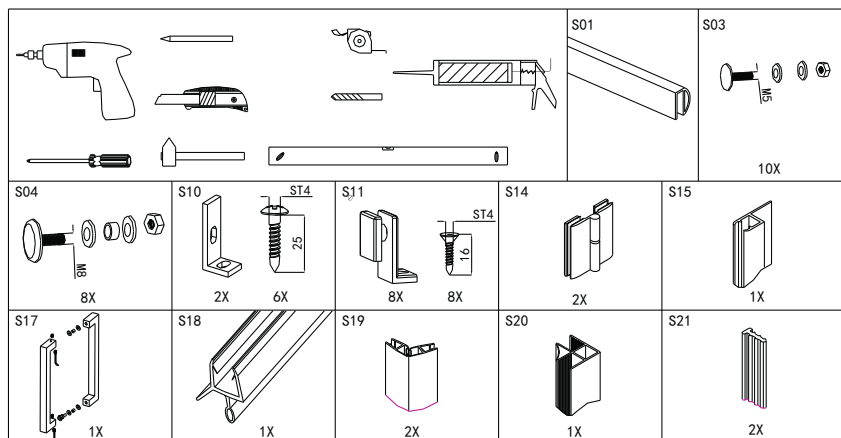
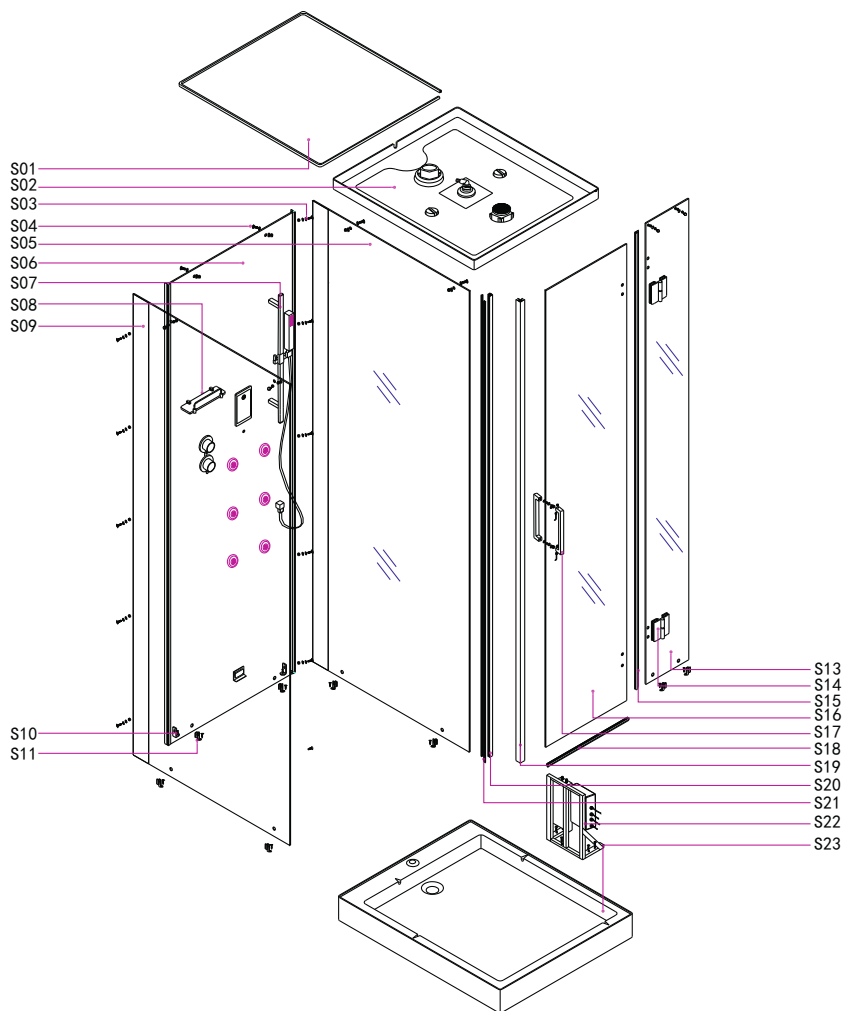

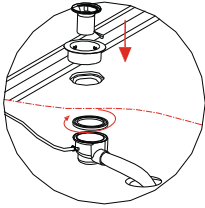
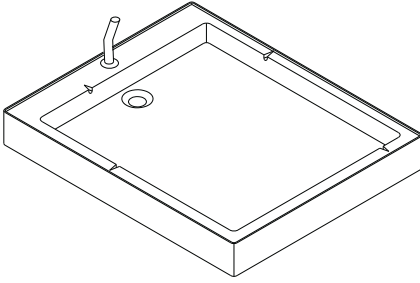
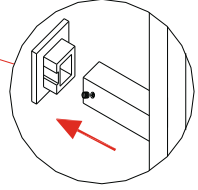
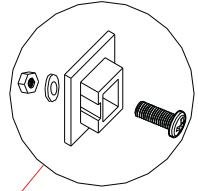
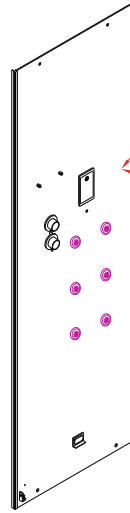
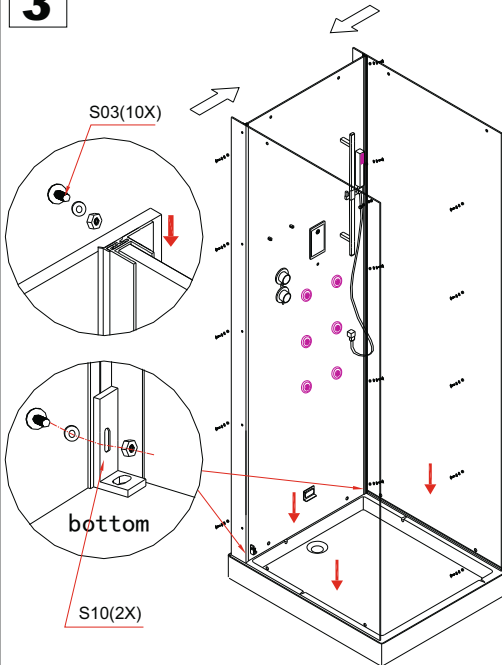
1**2****3**

S03(10X)

bottom

S10(2X)

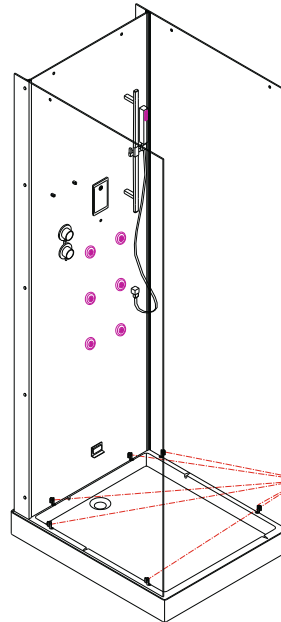
4

S11(6X)

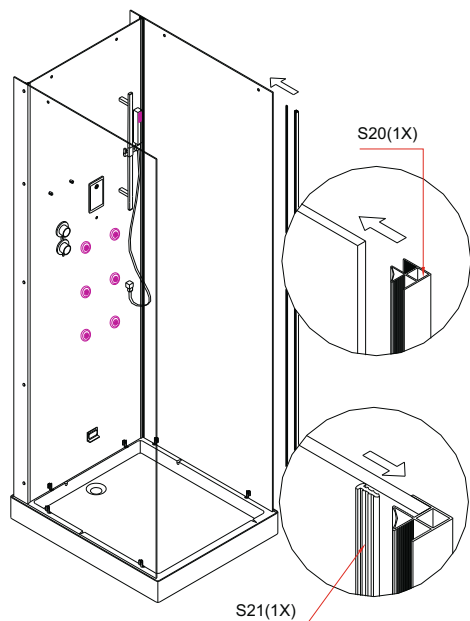
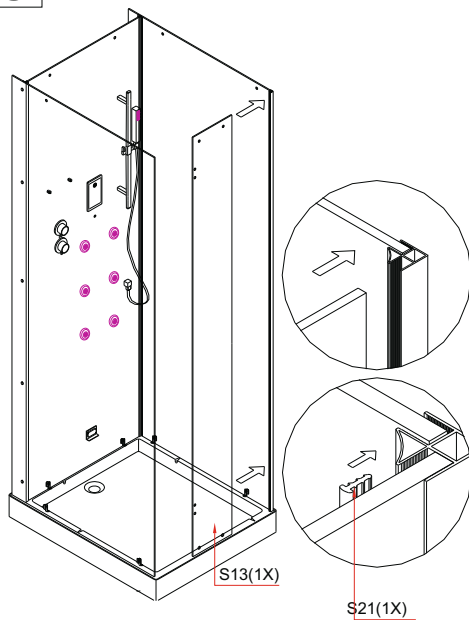
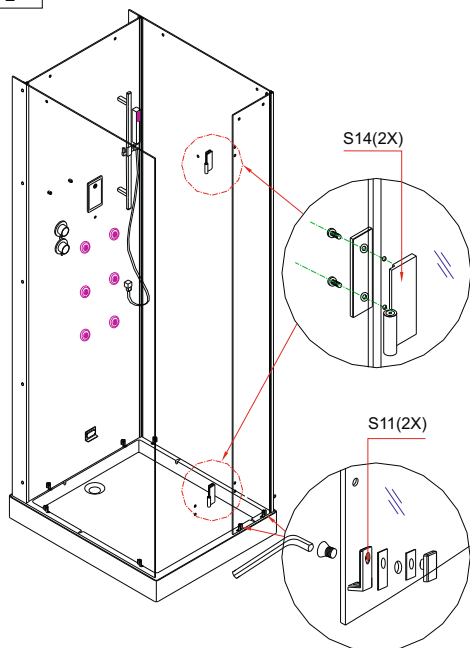
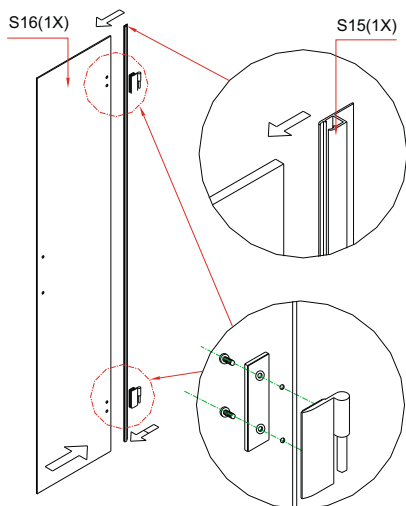
5**6****7****8**

9

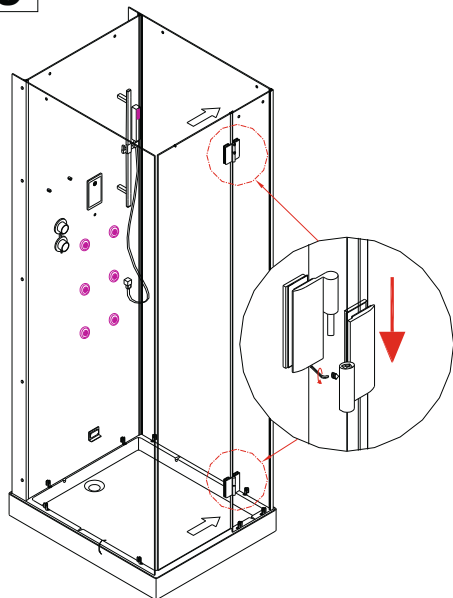

10

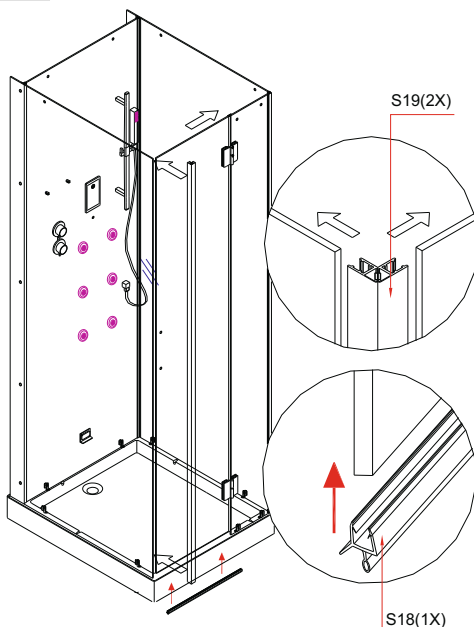

11

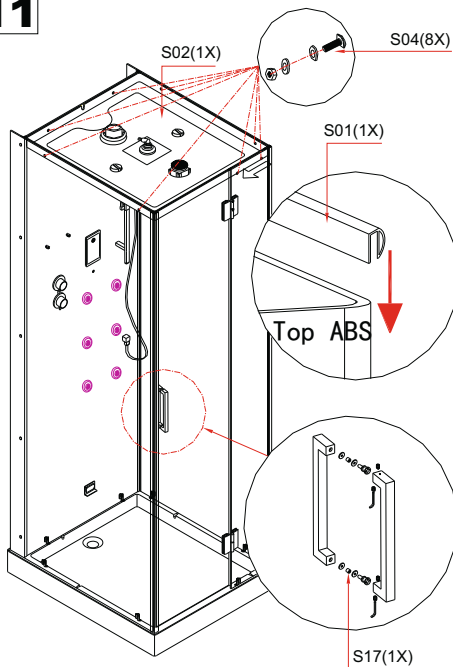

12

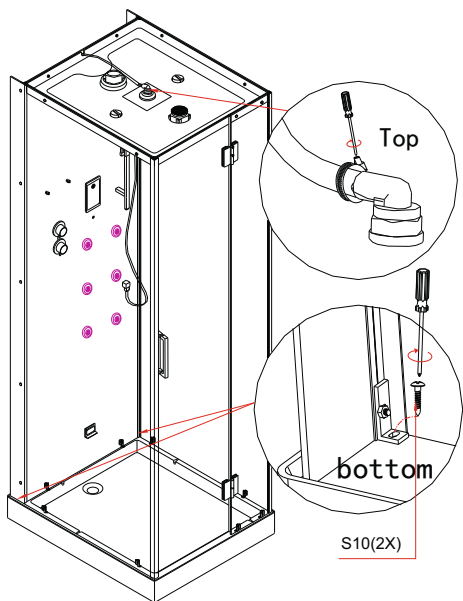

13

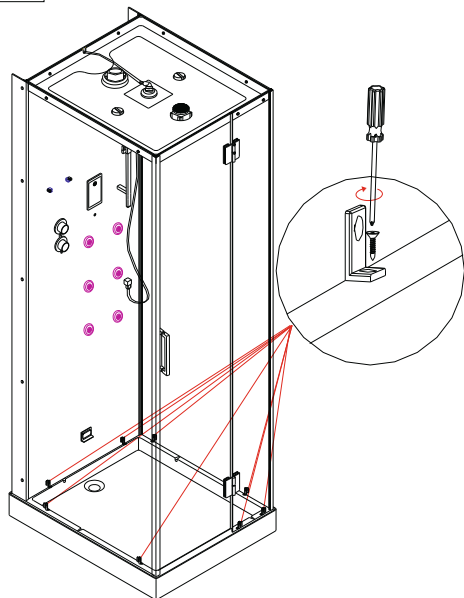

14

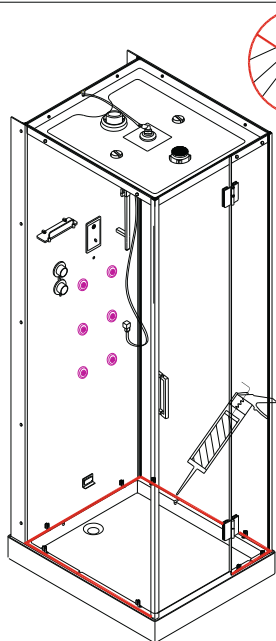
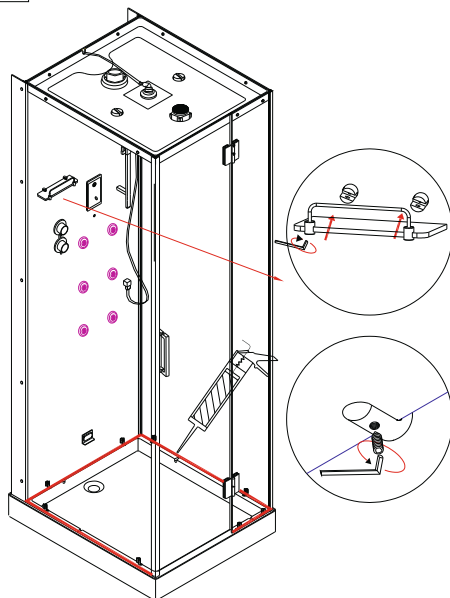

R

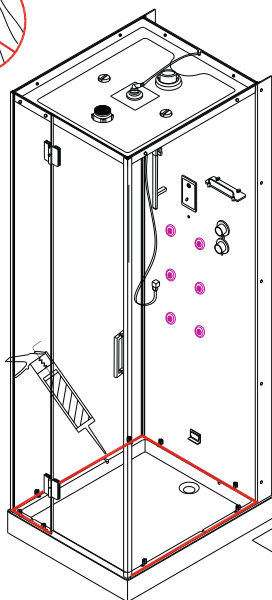

L

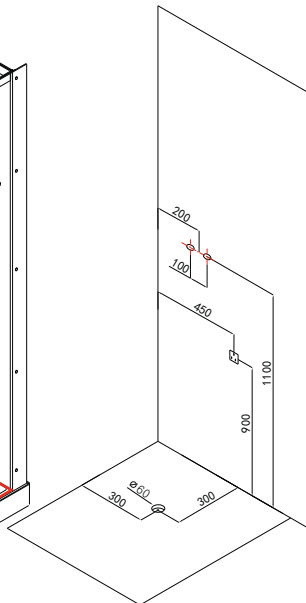

Control Panel Instruction Manual

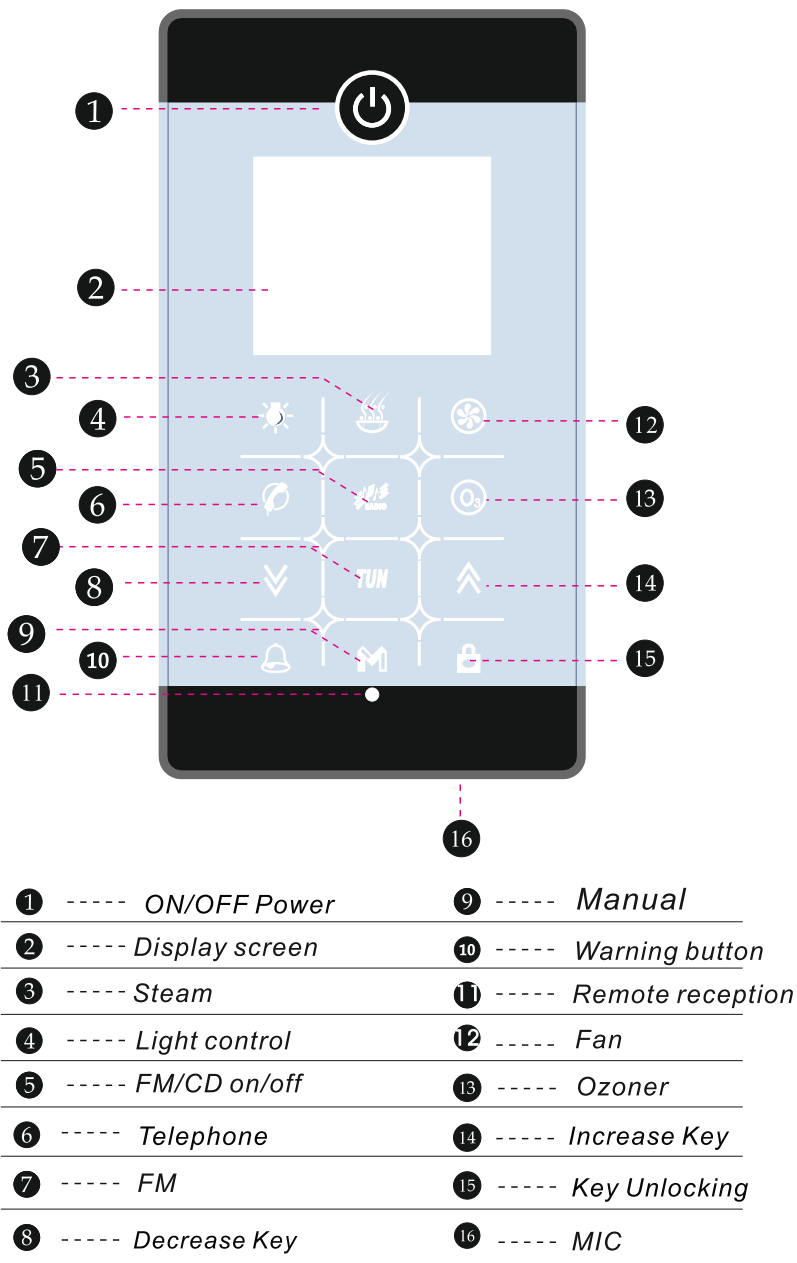



① ----- Temperature	⑧ ----- Ozoner
② ----- Temperature setting	⑨ ----- Telephone
③ ----- Time setting	⑩ ----- FM tuner
④ ----- Radio	⑪ ----- FM tuner setting
⑤ ----- CD	⑫ ----- Locked mark
⑥ ----- Lack of water	⑬ ----- Fan
⑦ ----- Steam	⑭ ----- Light

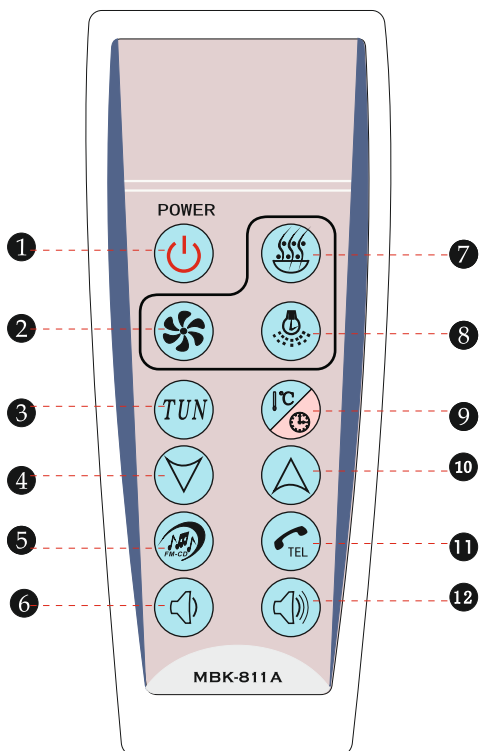



Remote

SEVILLA 110-L-R.pdf

①	-----	Power ON/OFF & Unlock	⑦	-----	Steam
②	-----	Fan ON/OFF	⑧	-----	Light ON/OFF
③	-----	FM Tuner Plus Key	⑨	-----	Steam
④	-----	Decrease	⑩	-----	Increase
⑤	-----	FM/CD	⑪	-----	Telephone
⑥	-----	Volume Decrease	⑫	-----	Volume Increase

Control Panel Operation Instructions

1. power on/off

When system on standby state, press this  key(2 seconds or more),then display on, simultaneously lights on;Press  key again,system off(if no any further operation in 1hour,system auto-off);When system off,touch the panel anywhere,key light will turn on,but it will be off in 5 seconds if no power on.



2. Ozoner

When system on, press the panel  key, ozone function will be turn on; then touch it once again,ozoner closes;and the same time,fan and light will be on.



3. Fan

When system on,touch the panel  key,fan will work on;then touch it once again,fan function closes;the same time there will be fan mark on/off in display.

4. light



When system on,Press the light  the light turn off, press the light  again,the light turn on. then pressing the light and the keep the light color, and then press the light  again , the light turn off.

5. FM/CD

When system on,firstly touch the panel  key,radio function on;and radio tuner display on;then touch its  key again,radio function switch into CD;and CD mark will show in display;and touch it once again,CD function shut off.



6. Radio tuner searching(radio on work)

①、Auto-search/store:press **TUN** key for 2 secs or more,auto-search/store function on,tuner range from 87.5-108.0MHZ(fixed tuner quantity 1-32 available,it depends on signal situation).

②、Man-search/store:touch **TUN** key,tuner will start flashing,press key  

to choose the one you like more,then touch the key **TUN** ,store the new tuner
(add new tuner into prefer-list).

③、Tuner switch:press key  /  to increase/decrease the tuner.





④、Volume adjustment: **TUN**press this key, and press key  /  to adjust the
voice volume(range from 0-15DB).

7. Steam



When system on,press the key  to start steam function,steam mark will
be on;(temperature set at 45 degrees and the time set at 45 minutes by default)



When lack of water,that mark flashes and steam shut off.

8. Telephone



When calling comes,speaker stops work pausely, press  key to answer
it,and tel mark stop flashing;when calling,you could adjust  /  to choose
right volume;and press key  again,phone off and speaker will be on.

9. Steam adjustment

①、steam time adjusting:key  to choose time, then press   key to in-de
crease steam time(range from 1-99mins).

②、 steam temperature:press  to choose temperature,key  /  to raise/
lower the temperature(range from 20-60℃).

10 . Unlocking

If there is no any further operation on touch panel in 20secs,system
will be locked auto,mark  will flashes, press  key for 2 secs or
more to unlock panel,then all of keys active on.

11 . Warning

When system on, press key  to open warning function,the same time
light and fan are all starting workingm;touch it again to shut it off.

Technical Information

Working Conditions and Property				
<i>Voltage Rating:</i>	AC 220 V	<i>Normal Frequency:</i>	50Hz～60Hz	
<i>Rated Current:</i>	13.6A	<i>Power Rating:</i>	2860W	
<i>Insulating Resistance:</i>	> 20 M	<i>Drain Current:</i>	<i>Measured upto enterprise safety standard</i>	
<i>Waterproof Grade:</i>	IPX5	<i>Leak Protection:</i>	(15 ~ 30)mA	
Load Configuration Parameters				
LOAD TYPE	RATED LOAD VOLTAGE	RATED LOAD FREQUENCY	RATED OPERATING POWER	QUANTITY
<i>Steam</i>	Ac220 V	50Hz/60Hz	2.8kW	1
<i>Top Light</i>	Dc 5 V	—	5W	1-2
<i>Exhaust</i>	Dc12 V	—	4W	1
<i>Electromagnetic Valve</i>	Dc12 V	—	5W	2
<i>Speaker</i>	—	—	8 Ω/10W	1-2
<i>Ozone Sterilizer</i>	Ac12 V	50Hz/60Hz	5W	1

Due to a policy of continous improvement the manufacturer reserves the right to change the specification without prior notice

WARNING!

Don't touch the steam outlet when the steam function is on ,and don't block it at anytime.

